



MORRIS

CIW-10715

Please read this manual carefully before use this product

USER MANUAL

COMBI WASHER DRYER

CONTENTS

SAFETY INSTRUCTIONS

- Safety Instructions 2

INSTALLATION

- Product Description8
- Installation 9

OPERATIONS

- Quick Start 12
- Before Each Washing 13
- Detergent Dispenser 14
- Control Panel 15
- Option..... 16
- Other Functions18
- Programmes20
- Washing Programmes Table 21

MAINTENANCES

- Cleaning And Care 22
- Trouble Shooting 25
- Technical Specifications 26
- Product Fiche 27

SAFETY INSTRUCTIONS

■ Safety Instructions

For your safety, the information in this manual must be followed to minimize the risk of fire or explosion, electric shock, or to prevent property damage, personal injury or loss of life. Explanation of the symbols:

Warning!

This combination of symbol and signal word indicates a potentially dangerous situation which may result in death or serious injuries unless it's avoided.

Caution!

This combination of symbol and signal word indicates a potentially dangerous situation which may result in slight or minor injuries or damage to property and the environment.

Note!

This combination of symbol and signal word indicates a potentially dangerous situation which may result in slight or minor injuries.

Warning!

The electric shock!

- If the supply cord is damaged, it must be replaced by the manufacturer, its service agent or similarly qualified persons in order to avoid a hazard.

SAFETY INSTRUCTIONS

- The new hose-sets supplied with the appliance are to be used and that old hose-sets should not be reused.
- Before any maintenance the device, unplug the appliance from the mains.
- Always unplug the machine and turn off the water supply after use. The max. inlet water pressure, in pascals. The min. inlet water pressure, in pascals.
- To ensure your safety, power plug must be inserted into an earthed three-pole socket. Check carefully and make sure that your socket is properly and reliably earthed.
- Make sure that the water and electrical devices **will** be connected by a qualified technician in accordance with the manufacturer's instructions and local safety regulations.

Risk to children!

- EN countries: the appliance can be used by children aged from 8 years and above and persons with reduced physical, sensory or mental capabilities or lack of experience and knowledge if they have been given supervision or instruction concerning use of the appliance in a safe way and understand the hazards involved. Children shall not play with the appliance. Cleaning and user maintenance shall not be made by children without supervision.
- Children of less than 3years should be supervised to ensure that they do not play with appliance.
- Animals and children may climb into the machine. Check the machine before every operation.
- Kids should be supervised that they do not play with the appliance.

SAFETY INSTRUCTIONS

- Glass door may be very hot during operation. Keep kids and pets far away from the machine during the operation **and do not use the machine in** very wet rooms as well as in rooms with explosive or caustic gas.
- Remove all packages and transport bolts before using the appliance. Otherwise, serious damage may result.
- Plug must be accessible after installation.

Risk of explosion!

- **Do not wash or dry articles that have been cleaned in, washed in, soaked in, or dabbed with combustible or explosive substances (such as wax, oil, paint, gasoline, degreasers, dry-cleaning solvents, kerosene, etc.) This may cause fire or explosion.**
- **The washer dryer is not to be used if industrial chemicals have been used for cleaning.**
- **The exhaust air must not be discharged into a flue which is for exhausting fumes from appliances burning gas or other fuels.**
- **Before hand thoroughly rinse items of washing by hand.**

⚠ Caution!

Installing the product!

- This washing machine is for indoor use only.
- It isn't intended to be built-in using.
- The openings must not be obstructed by carpets.
- Washing machine shall not be installed in bath room or very wet rooms as well as in the rooms with explosive or caustic gases.
- The washing machine with single inlet valve only can be connected to the cold water supply. The product with double inlet valves should be correctly connected to the hot water and cold water supply.
- Plug must be accessible after installation.

SAFETY INSTRUCTIONS

- **The appliance must not be installed behind a lockable door, a sliding door or a door with a hinge on the opposite side to that of the washer dryer.**
- **The appliance shall not be installed at a humid place.**
- Remove all packages and transport bolts before using the appliance. Otherwise, serious damage may result.

Risk of damaging appliance!

- Your product is only for home use and is only designed for the textiles suitable for machine washing.
- Do not climb up and sit on top cover of the machine.
- Do not lean against machine door.
- Cautions during **handling / carrying the machine**:
 1. Transport bolts shall be re-installed to the machine by a specialized person.
 2. The accumulated water shall be drained out of the **machine**.
 3. Handle the machine carefully. Never hold each protruded part on the machine while lifting. Machine door can not be used as the handle during the conveyance.
 4. This appliance is heavy. Transport / **carry it** with care.
 5. **Hands shall not be inserted into running water extracting tub.**
- Please do not close the door with excessive forces. If it is found difficult to close the door, please check if the clothes are put in or distributed well.
- It is forbidden to wash carpets.

Operating the appliance!

- **Before using the washing machine should be calibrated.**
- Before washing the clothes at first time, the product shall be operated in one round of the whole procedures without **any** clothes inside.
- Flammable and explosive or toxic solvents are forbidden. Gasoline and alcohol etc. shall not be used as detergents. Please only select the detergents suitable for machine washing, especially for drum.

SAFETY INSTRUCTIONS

- Make sure that all pockets are emptied. Sharp and rigid items such as coin, brooch, nail, screw or stone etc. may cause serious damages to this machine.
- Please check whether the water inside the drum has been drained before opening its door. Please do not open the door if there is any water visible.
- Be careful of burning when the product drains hot washing water.
- Never refill the water by hand during washing.
- After the program is completed, please wait for two minutes to open the door.

If it is unavoidable that fabrics that contain vegetable or cooking oil or have been contaminated by hair care products, to be placed in a tumble dryer they should first be washed in hot water with extra detergent. This will reduce, but not eliminate, the hazard. Adequate ventilation has to be provided to avoid the back flow of gases into the room from appliances burning other fuels, including open fires.

Do not dry unwashed clothes / fabrics in the appliance. Clothes / fabrics that have been soiled with substances such as cooking oil, acetone, alcohol, petrol, kerosene, spot removers, turpentine, waxes and wax removers should be washed in hot with an extra amount of detergent before being dried in the appliance.



Warning!

This appliance is intended to be used in household and applications such as

- Staff kitchen areas in shops, offices and other working environments;
- Farm houses;
- By clients in hotels, motels and other residential type environments;
- Bed and breakfast type environments;
- Areas for communal use in blocks of flats or in laundrettes;

SAFETY INSTRUCTIONS

Items such as foam rubber (latex foam), shower caps, water proof textiles, rubber backed articles and clothes or pillows fitted with foam rubber pads should not be dried in the machine.

Fabric softeners, or similar products, should be used as specified by the fabric softener instructions.

The machine whose lid can be opened during water extraction, that it takes 15s or more for complete stop of water extracting chamber tub.

The final part of a washer dryer cycle occurs without heat (cool down cycle) to ensure that the items are left at a temperature that ensures that the items will not be damaged.

Remove all objects from pockets such as lighters and matches before use the appliance.

WARNING: Never stop a washer dryer before the end of the drying cycle unless all items are quickly removed and spread out so that the heat is dissipated.

Packaging / Old appliance



This marking indicates that this product should not be disposed with other household wastes throughout the EU. To prevent possible harm to the environment or human health from uncontrolled waste disposal, recycle it responsibly to promote the sustainable reuse of material resources. To return your used device, please use the collection systems or contact the retailer where the product was purchased. They return and can take this product for environmental safe recycling.

INSTALLATION

■ Product Description

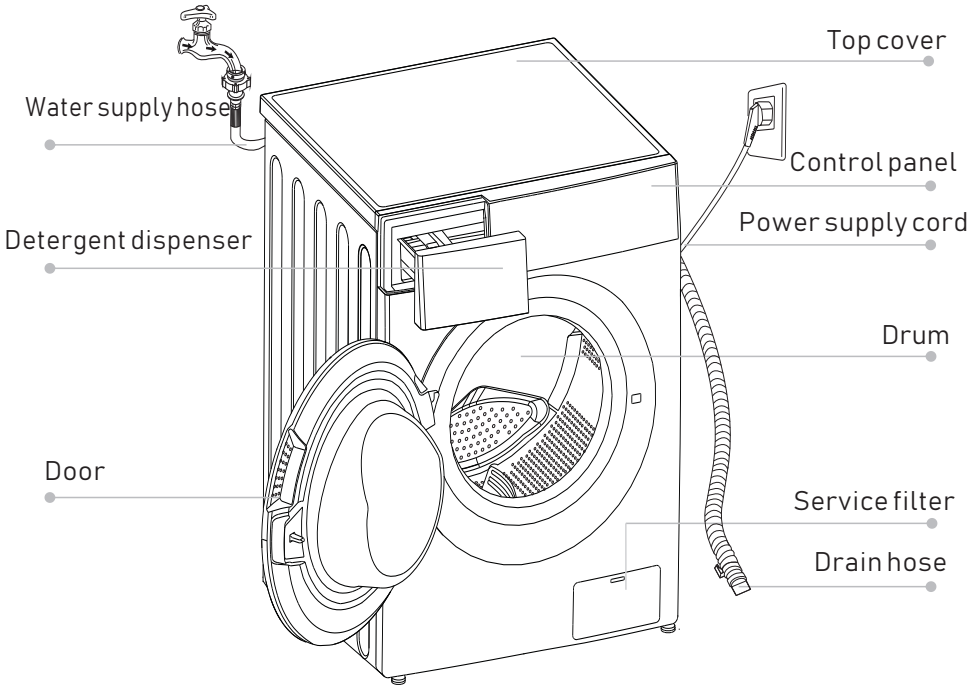

📌 Note!

- The product line chart is for reference only, please refer to real product as standard.

Accessories

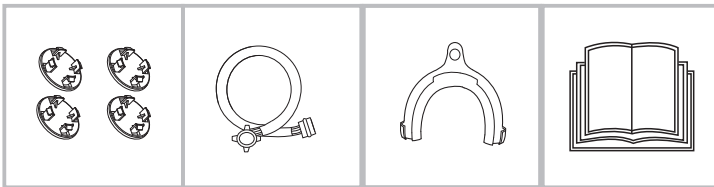

Transport hole plug

Supply hose cold water

Drain hose support (optional)

Owner's manual

INSTALLATION

■ Installation

Installation area

⚠ Warning!

- Stability is important to prevent the product from wandering!
- Make sure that the product should not stand on the power cord.

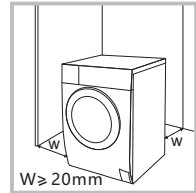

Before installing the machine, the location characterized as follows shall be selected:

1. Rigid, dry, and level surface
2. Avoid direct sunlight
3. Sufficient ventilation
4. Room temperature is above 0°C
5. Keep far away from the heat resources such as coal or gas.

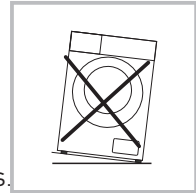

Unpacking the washing machine

⚠ Warning!

- Packaging material (e.g. Films, Styrofoam) can be dangerous for children.
- There is a risk of suffocation! Keep all packaging well away from children.

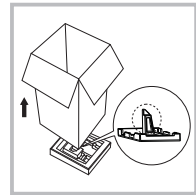

1. Remove the cardboard box and styrofoam packing.
2. Lift the washing machine and remove the base packing. Make sure the small triangle foam is removed with the bottom one together. If not, lay the unit down with side surface, then remove the small foam from the unit bottom manually.
3. Remove the tape securing the power supply cord and drain hose.
4. Remove the inlet hose from the drum.

Remove transport bolts

⚠ Warning!

- You must remove the transport bolts from the backside before using the product.
- You'll need the transport bolts again if you move the product, so make sure you keep them in a safe place.

Please take the following steps to remove the bolts:

1. Loosen 4 bolts with spanner and then remove them.
2. Stop the holes with transport hole plugs.
3. Keep the transport bolts properly for future use.

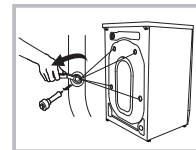

INSTALLATION

Levelling the washing machine

⚠ Warning!

- The lock nuts on all four feet must be screwed tightly against the housing.

1. Check if the legs are closely attached to the cabinet. If not, please turn them to their original positions tighten the nuts.
2. Loosen the lock nut turn the feet until it closely contacts with the floor.
3. Adjust the legs and lock them with a spanner, make sure the machine is steady.

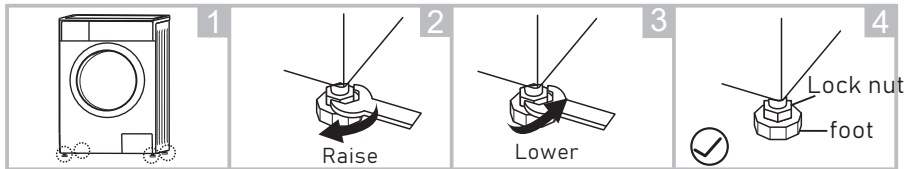

Connect Water Supply Hose

⚠ Warning!

- To prevent leakage or water damage, follow the instructions in this chapter !
- Do not kink, crush, modify or sever water inlet hose .
- For the model equips hot valve, connect it to hot water tap with hot water supply hose. Energy consumption will decrease automatically for some program.

Connect the inlet pipe as indicated. There are two ways to connect the inlet pipe.

1. Connection between ordinary tap and inlet hose.

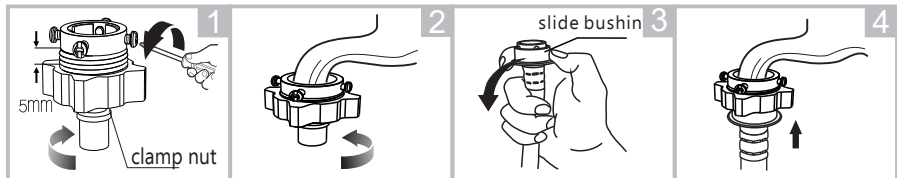

Loosen clamp nut and four bolts Tighten clamp nut Press slide bushing insert inlet hose into connecting base ,Connection finished

2. Connection between screw tap and inlet hose.

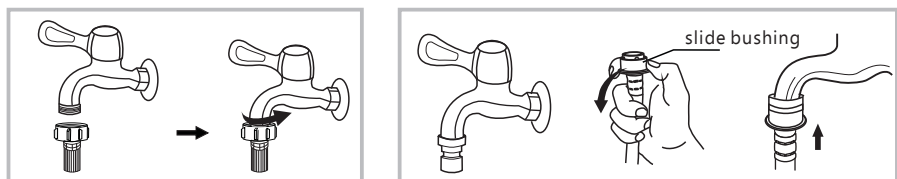

Tap with threads and inlet hose

Special tap for washer dryer

INSTALLATION

Connect the other end of inlet pipe to the inlet valve at the backside of product and fasten the pipe tightly clockwise.

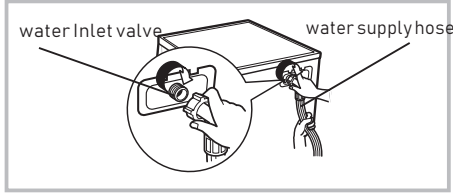

Drain Hose

⚠ Warning!

- Do not kink or protract the drain hose.
- Position drain hose properly ,otherwise damage might result of water leakage.

There are two ways to place the end of drain hose:

1.Put it into the water trough.

2.Connect it to the branch drain pipe of the trough.

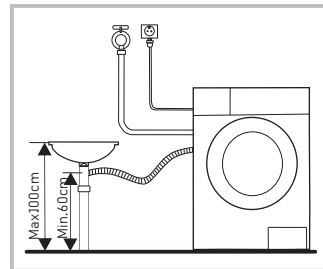
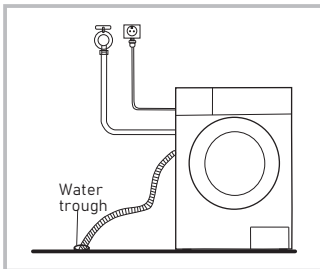

📌 Note!

- If the machine has drain hose support, please install it like the following .

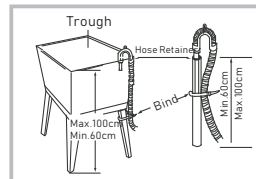
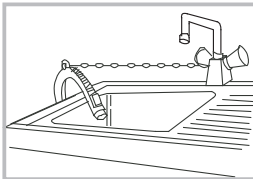

⚠ Warning!

- When installing drain hose, fix it properly with a rope.
- If drain hose is too long, do not force it into washing machine as it will cause abnormal noises.

OPERATIONS

■ Quick Start

⚠ Caution!

- Before washing, please make sure it's installed properly.
- Before washing at first time, the washing machine shall be operated in one round of the whole procedures without clothes in as follows.

📌 Calibration

It is recommend to calibrate the washing machine before first use

- 1- Empty the wash machine;
- 2- Plug in;
- 3- Power on the wash machine and press **Speed** and **Delay** at the same time within 10 seconds then display **"t19"**
- 4- Press **▶||** to start the wash machine and wait till display **"*****"**

1. Before Washing

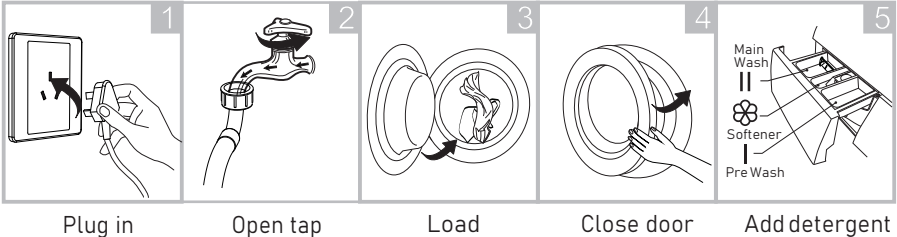

📌 Note!

- Detergent need to be added in "case I" after selecting pre-washing for machines with this function.

2. Washing

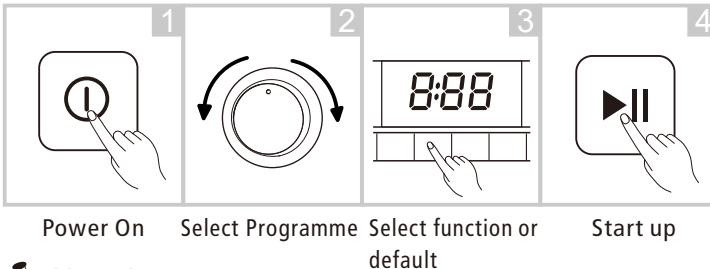

📌 Note!

- 1.If default is selected, step 3 can be skipped.
- 2.The function button line chart is for reference only, please refer to real product as standard.

3. After Washing

Buzzer beep or "End" on display.

OPERATIONS

■ Before Each Washing

- The working condition of the washer should be (0-40)°C. If used under 0°C, the inlet valve and draining system may be damaged. If the machine is placed under condition of 0°C or less, then it should be transferred to normal ambient temperature to ensure the water supply hose and drain hose are not frozen before use.
- Please check the labels and the explanation of using detergent before wash. Use non-foaming or less-foaming detergent suitable for machine washing properly.

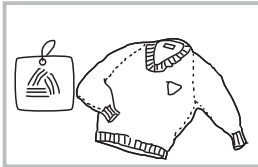

Check the label

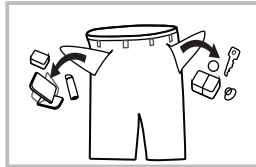

Take out of the pockets
the items



Knot the long strips, zip or
buttons

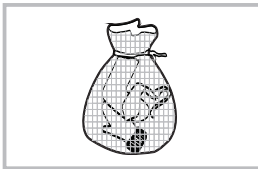

Put small clothes into the
pillow slip

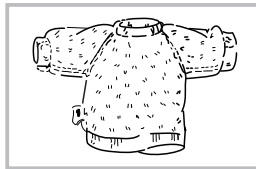

Turn easy-pilling and
long-pile fabric inside out

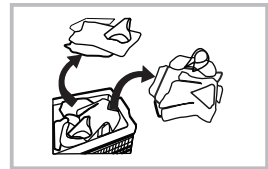

Separate clothes with
different textures

⚠ Warning!

- When washing a single clothe, it may easily cause great eccentricity and give alarm due to great unbalance. Therefore it is suggested to add one or two more clothes to be washed together so that draining can be done smoothly.
- Don't wash **any** cloth touched by kerosene, gasoline, alcohol and other flammable materials.

OPERATIONS

■ Detergent Dispenser

- I Pre wash detergent
- II Main wash detergent
- ☼ Softener

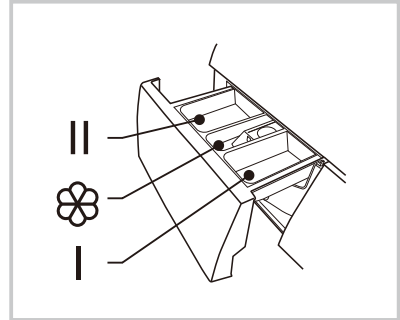

Pull out the dispenser

⚠ Caution!

- Detergent only need to be added in "case I "after selecting pre-washing for machines with this function.

Programme	I	II / △	☼	Programme	I	II / △	☼
Cotton	○	●	○	Wool		●	○
Synthetic	○	●	○	ECO 40-60		●	○
Mix	○	●	○	Intensive		●	○
Bed Linen	○	●	○	Quick 15'		●	○
Baby Care	○	●	○	Dry Only			
20°C		●	○	1h W/D		●	○
Drum Clean				Wash and Dry		●	○
Spin Only						●	○
Rinse & Spin			○				

- Means must
- Means optional

📌 Note!

- As for the agglomerated or ropy detergent or additive, before they are poured into the detergent box, it is suggested to use some water for dilution to prevent the inlet of detergent box from being blocked and overflowing while filling water.
- Please choose suitable type of detergent for the various washing temperature to get the best washing performance with less water and energy consumption.

OPERATIONS

■ Control Panel

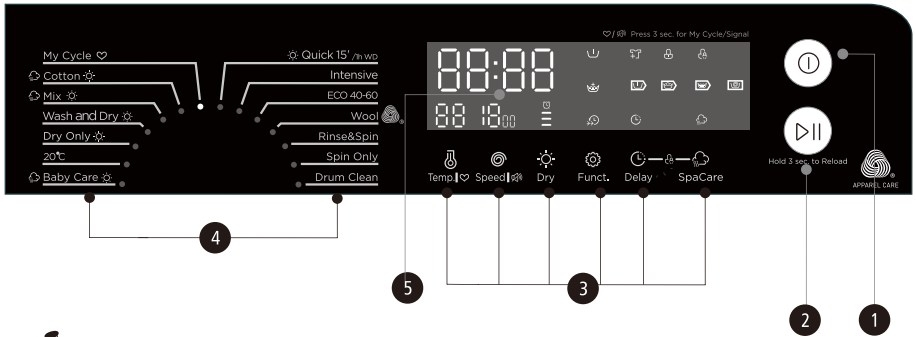

Note!

- The chart is for reference only, Please refer to real product as standard.

1 On/Off

Product is switched On/Off.

2 Start/Pause

Press the button to start or pause the washing cycle.

3 Option

This allows you to select an additional function and will light when selected.

4 Programmes

Available according to the laundry type.

5 Display

The display shows the settings, estimated time remaining, options, and status messages for your washer. The display will remain on through the cycle.

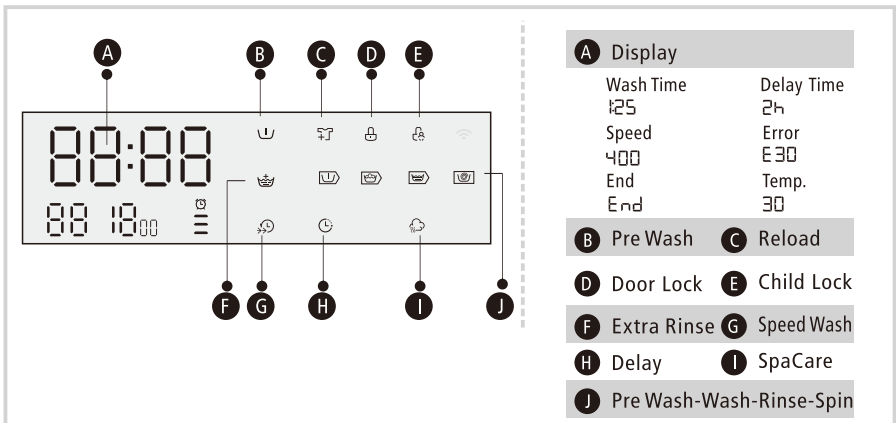

OPERATIONS

■ Option

Delay

Delay

Set the Delay function:

1. Select a programme;
2. Press the Delay button to choose the time (the delaying time is 0–24 H.);
3. Press [Start/Pause] to commence the delay operation



Choose the Programme Setting time

Start

Cancel the Delay function:

Press the [Delay] button until the display be 0H. It should be pressed before starting the programme. If the programme already started, should switch off programme to reset a new one.

Soil Level

Soil

The washing time will increase or decrease after you select it.

⚠ Caution!

- If there is any break in the power supply while the machine is operating, a special memory stores the selected programme and when the power is restarted, the program will continue.

Pre Wash

Pre Wash

The Prewash function can get an extra wash before main wash, it is suitable for washing the dust rises to surface of the clothes. You need to put detergent into the Case (I) when select it.

Extra Rinse

Extra Rinse

The laundry will undergo extra rinse once after you select it.

Speed Wash

Speed Wash

The function can decrease the washing time.



My Cycle

To memory the frequently used programme.

After choosing the programme and setting the options, press [Temp.] 3 sec. before start to wash. The default setting course is Cotton.

Note: Operations are for reference only. Please refer to the actual product

OPERATIONS



Reload

This operation can be executed during the washing progress. When the drum is still rolling and there is large amount of water with high temperature in the drum. The state is unsafe and the door cannot be opened forcefully. To press [Start/Pause] for 3 sec. to reload, and start the clothes adding in the midway function. Please follow the steps as bellow:

- 1.Wait until the drum stops rotation.
- 2.The door lock is unlocked.
- 3.Close the door when the clothes are reloaded and press the [Start/Pause] button.



Press[Start/Pause]3sec.



Reload the clothes



Start

SpaCare

SpaCare

SpaCare function can be selected by choose "Cotton", "Bed Linen" and "BabyCare". The customers can see the steam in the drum when operate SpaCare function. The SpaCare cannot be used simultaneously With Pre Wash and Speed Wash.

! Caution!

- Don't use the Reload function when the water level over the edge of the inner tub or the temperature is higher.

Note: Operations are for reference only. Please refer to the actual product

OPERATIONS

■ Other Functions

Temp.

Temp.

Press the button to regulate the temperature(Cold,20°C,30°C, 40°C,60°C,90°C)

Speed

Speed

Press the button to change the speed.

1500: 0-400-600-800-1000-1200-1400-1500

Programme	Default Speed(rpm)	Programme	Default Speed(rpm)
	1500		1500
Cotton	1500	Spin Only	1000
Mix	800	Rinse & Spin	1000
Wash and Dry	1500	Wool	600
Dry Only	1500	ECO 40-60	1500
20°C	1000	Intensive	800
Baby Care	800	Quick 15'/1h WD	800
Drum Clean	-		

OPERATIONS



Child Lock

To avoid mis operation by children.



Press [Delay] and [SpaCare]
3 sec. till buzzer beep.

⚠ Caution!

When child lock is activated and program starts, child lock indicator will switch on, and the CL and remaining time on the display are alternately displayed in 0.5s.

Press the other buttons will make child lock indicator flash for 3s. when program finish, CL and END alternate for 10s in 0.5s, then the child lock lights flash for 3s

- Only press and hold the two button can release child lock, even power off, switch off and program end
- The "Child Lock" will lock all buttons except Power button and Child Lock button
- Please release child lock before selecting program and staring washing



Mute the buzzer



Choose the Programme



Press the [Speed] button for 3sec.,
the buzzer is mute.

To act the buzzer function, press the button again for 3 seconds. The setting will be kept until the next reset.

⚠ Caution!

- After Muting the buzzer function, the sounds will not be activated any more.



Dry

Press the Dry button continuously to choose the dry level: Extra Dry/Normal Dry (Normal)/Gentle Dry(Soft).

- ≡ Extra Dry: Need to wear clothes immediately, we can choose this function;
- = Normal Dry(Normal): The normal dry procedure;
- Gentle Dry(Soft): Only to dry slightly and then is just ok;
- 🕒 Timed Dry: We can choose this function to dry clothes for a specific time.

OPERATIONS

■ Programmes

Programmes are available according to the laundry type.

Programmes	
Cotton	Hard-wearing textiles, heat-resistant textiles made of cotton or linen.
Synthetic	Wash synthetic articles, for example: shirts, coats, blending. While washing the knitting textiles, detergent quantity shall be reduced due to its loose string construction and easily forming bubbles.
Baby Care	Washing the baby's clothes, it can make the baby's wear cleaner and make the rinse performance better to protect the baby skin.
Mix	Mixed load consisting of textiles made of cotton and synthetics.
Bed Linen	This program is specially designed for washing duvet coats..
20°C	20°C default, can choose cold water.
ECO 40-60	Default 40°C, not selectable, suitable for laundry washing at about 40°C-60°C.
Quick 15'	Extra short programme approx, suitable for lightly soiled washing as a small amounts of laundry.
1h WD	For small synthetic clothes or shirts, load limitation is 1 kg (about 4 shirts).
Wool	Hand or machine-washable wool or richwool textiles. Especially gentle wash programme to prevent shrinkage, longer programme pauses (textiles rest in wash liquor).
Spin Only	Extra spin with selectable spin speed.
Rinse&Spin	Extra rinse with spin.
Intensive	To increase the washing effects, washing time is increased.
Drum Clean	Specially set in this machine to clean the drum and tube. It applies 90 °C high temperature sterilization to make the clothes washing more green. When this programme is performed, the clothes or other washing cannot be added. When proper amount of chlorine bleaching agent is put in, the barrel cleaning effect will be better. The customer can use this programme regularly according to the need.
Dry Only	Select it to dry clothes, the temperature is different. The drying time according to the load.
Wash and Dry	The standard energy program.

OPERATIONS

■ Washing Programmes Table

Programme	Load(kg)	Temp.(°C)	Default Time
	10.0	Default	8.0/10.0
☀ Cotton	10.0/7.0	40	3:39
☀ Mix	5.0/5.0	40	1:20
☀ Wash and Dry	10.0/7.0	-	4:54
☀ Dry Only	-7.0	-	4:14
20°C	10.0	20	1:01
☀ Baby Care	10.0/5.0	60	1:42
Drum Clean	-	90	1:18
Spin Only	10.0	-	0:12
Rinse&Spin	10.0	-	0:20
Wool	2.0	40	1:07
ECO 40-60	10.0	-	3:35/3:53
Intensive	10.0	40	3:48
☀ Quick 15'/1h WD	2.0/1.0	Cold	0:15

- Concerning to Regulation(EU) No 1061/2010,
The EU energy efficiency class is: A
Energy test program: Intensive;Speed:The highest speed; Temp.: 60°C;
Other as the default.
Half load for 8.0/10.0Kg machine:4.0/5.0Kg.
- Concerning to Regulation(EU) 2019/2023,
The EU energy efficiency class is: E/D
Energy test program: ECO 40-60/Wash & Dry.
ECO 40-60: as the default
Wash And Dry : dry level:☰ (Extra Dry),Other as the default.
Half load for 8.0/10.0Kg machine:4.0/5.0Kg.
Quarter load for 8.0/10.0Kg machine:2.0/2.5Kg.

Note!

- The parameters in this table are only for user's reference. The actual parameters may be different with the parameters in above mentioned table.

MAINTENANCES

■ Cleaning And Care

Warning!

- Before your maintenance starts, please unplug the machine and close the tap.

Cleaning The Cabinet

Proper maintenance on the washing machine can extend its working life. The surface can be cleaned with diluted non-abrasive neutral detergents when necessary. If there is any water overflow, use the wet cloth to wipe it off immediately. No sharp items are allowed.

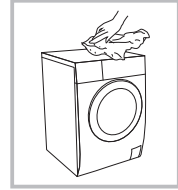

Note!

- Formic acid and its diluted solvents or equivalent are forbidden, such as alcohol, solvents or chemical products, etc.

Cleaning The Drum

The rusts left inside the drum by the metal articles shall be removed immediately with chlorine-free detergents. Never use steel wool.

Note!

- Don't put laundry in the washing machine during the drum cleaning.

Cleaning The Door Seal And Glass

Wipe the glass and seal after each wash to remove lint and stains. If lint builds up it can cause leaks. Remove any coins, buttons and other objects from the seal after each wash.

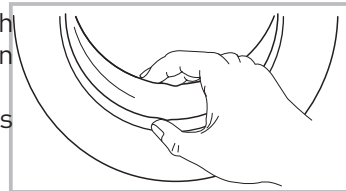

MAINTENANCES

Cleaning The Inlet Filter

Note!

- Inlet filter must be cleaned if there is less water.

Washing the filter in the tap

1. Close the tap.
2. Remove the water supply hose from the tap.
3. Clean the filter.
4. Reconnect the water supply hose.

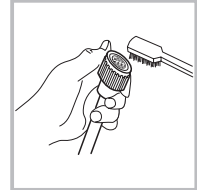
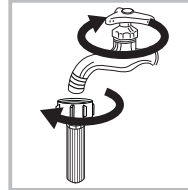

Washing the filter in washing machine:

1. Screw off the inlet pipe from the backside of the machine.
2. Pull out the filter with long nose pliers and reinstall it back after being washed.
3. Use the brush to clean the filter.
4. Reconnect the inlet pipe.

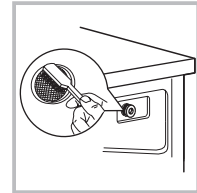
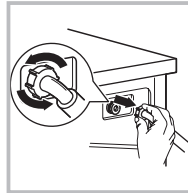

Note!

- If the brush is not clean, you can pull out the filter washed separately;
- Reconnect, turn on the tap.

Clean The Detergent Dispenser

1. Press down the arrow location on softener cover inside the dispenser drawer.
2. Lift the clip up and take out softener cover and wash all grooves with water.
3. Restore the softener cover and push the drawer into position.

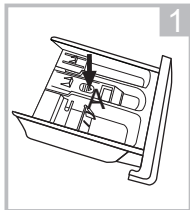

1

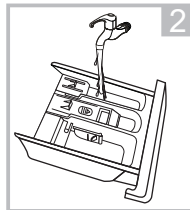

2

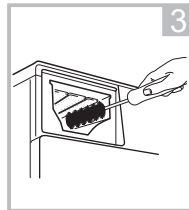

3

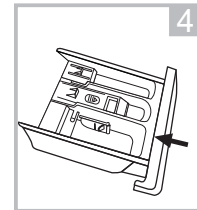

4

- Pull out the dispenser drawer with press the A
Clean the dispenser drawer under water
Clean inside the recess with an old toothbrush
Insert the dispenser drawer

Note!

- Do not use alcohol, solvents or chemical products to clean the machine.

MAINTENANCES

Cleaning The Drain Pump Filter

⚠ Warning!

- Be careful of the hot water!
- Allow detergent solution to cool down.
- Unplug the machine to avoid electrical shock before washing.
- Drain pump filter can filter the yarns and small foreign matters from the washing.
- Clean the filter periodically to ensure the normal operation of washing machine.

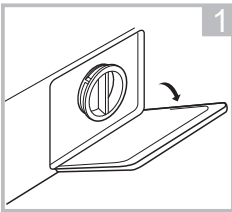

Open the lower cover cap

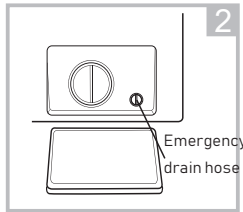

Rotate 90°C and pull out the emergency drain hose, and take off the hose cap

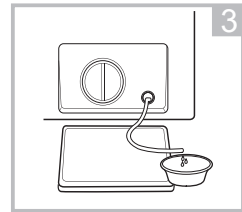

After water runs out, Reset the drain hose

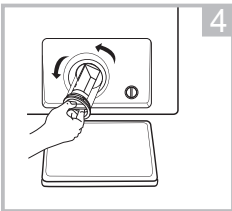

Open the filter by turning to the counter clockwise

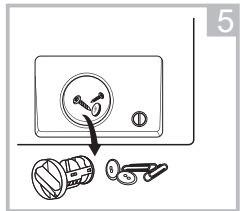

Remove extraneous matter

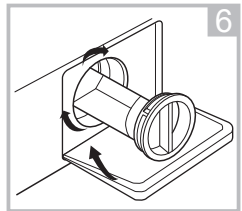

Close the lower cover cap

⚠ Caution!

- Make sure that valve cap and emergency drain hose are reinstalled properly, cap plates should be inserted aligning to hole plates otherwise water may leak.
- Some machines don't have emergency drain hose, so step 2 and step 3 can be skipped. Rotate lower cover cap directly to make water run into basin.
- When the appliance is in use and depending on the programme selected there can be hot water in the pump. Never remove the pump cover during a wash cycle, always wait until the appliance has finished the cycle, and is empty. When replacing the cover, ensure it is securely re-tightened.

MAINTENANCES

■ Trouble Shooting

The start of the appliance does not work or it stops during operation. First try to find a solution to the problem. If not, contact the service centre.

Description	Reason	Solution
Washer dryer cannot start up	Door is not closed properly	Restart after the door is closed Check if the clothes is stuck
Door can't be opened	Washer's safety protection design is working	Disconnect the power, restart the product
Water leakage	The connection between inlet pipe or outlet hose is not tight	Check and fasten water pipes Clean up outlet hose
Detergent residues in the box	Detergent is dampened or agglomerated	Clean and wipe the detergent box
Indicator or display does not light	Disconnect the power PC board or harness has connection problem	Check if the power is shut down and the power plug is connected correctly
Abnormal noise		Check if the fixing (bolts) have been removed Check it's installed on a solid and level floor

Description	Reason	Solution
E30	Door is not closed properly	Restart after the door is closed Check if the clothes is stuck
E10	Water injecting problem while washing	Check if the water pressure is too low Straighten the water pipe Check if the inlet valve filter is blocked
E21	Overtime water draining	Check if the drain hose is blocked
E12	Water overflow	Restart the washer
EXX	Others	Please try again first, call up service line if there are still troubles

Note!

- After the check, activate the appliance. If the problem occurs or the display shows other alarm codes again, contact the service.

MAINTENANCES

■ Technical Specifications

Power Supply 220-240V~,50Hz(EU)

MAX.Current 10A

Standard Water Pressure 0.05MPa~1MPa

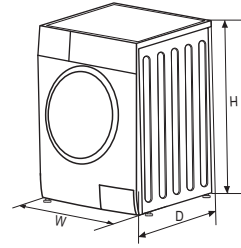

Model	Washing Capacity	Dimension (W*D*Hmm)	Net Weight	Rated Power
CIW-10715	10.0kg	595*565*850	74kg	1900W



The wool wash cycle of this machine has been approved by The Woolmark Company for the washing of machine washable wool products provided that the products are washed according to the instructions on the garment label and those issued by the manufacturer of this washing machine.M1529

MAINTENANCES

Supplier's name or trade mark:



Supplier's address (°):

87A, 17th November str, 55535, Pylea, Thessaloniki

Model identifier:

CIW-10715

General product parameters:

Parameter	Value		Parameter	Value	
Rated capacity (kg)	Rated capacity ^(b)	7.0	Dimensions in cm	Height	85
	Rated washing capacity ^(b)	10.0		Width	60
				Depth	57
Energy Efficiency Index	EEI _w ^(a)	60.0	Energy efficiency class	EEI _w ^(a)	B
	EEI _{WD} ^(b)	67.0		EEI _{WD} ^(b)	D
Washing efficiency index	I _w ^(a)	1.04	Rinsing effectiveness (g/kg dry textile)	I _R ^(a)	5
	J _w ^(b)	1.04		J _R ^(b)	5
Energy consumption in kWh per kg per cycle, for the washing cycle of the household washer-dryer, using the eco 40-60 programme at a combination of full and partial loads. Actual energy consumption will depend on how the appliance is used	0.593		Energy consumption in kWh per kg per cycle, for the wash and dry cycle of the household washer-dryer at a combination of full and half loads. Actual energy consumption will depend on how the appliance is used	3.430	
Water consumption in litre per cycle, for the eco 40-60 programme at a combination of full and partial loads. Actual water consumption will depend on how the appliance is used and on the hardness of the water	52		Water consumption in litre per cycle, for the wash and dry cycle of the household washer-dryer at a combination of full and half loads. Actual water consumption will depend on how the appliance is used and on the hardness of the water	100	
Maximum temperature inside the treated textile (°C) ^(a)	Rated washing capacity	38	Remaining moisture content ^(a) (%)	Rated capacity	53
	Half	38		Half	53
	Quarter	20		Quarter	53
Spin speed (rpm) ^(a)	Rated washing capacity	1500	Spin-drying efficiency class ^(a)	B	
	Half	1500			
	Quarter	1500			
Eco 40-60 programme duration (h:min)	Rated washing capacity	3:59	wash and dry cycle duration (h:min)	Rated capacity	9:40
	Half	3:00		Half	7:00
	Quarter	3:00			

MAINTENANCES

Airborne acoustical noise emissions during the spinning phase for the eco 40-60 washing cycle at rated washing capacity	80	Airborne acoustical noise emission class for the spinning phase for the eco 40-60 programme at rated washing	C
Type	[built-in/free-standing]	free-standing	
Off-mode (W)	0.50	Standby mode (W)	1.00
Delay start (W) (if applicable)	4.00	Networked standby (W) (if applicable)	NA

Minimum duration of the guarantee offered by the supplier (°):

This product has been designed to release silver ions during the washing cycle	NO
--	----

Additional information:

Weblink to the supplier's website, where the information in point 9 of Annex II to Regulation (EU) 2019/2023 is found (°):







(°) for the eco 40-60 programme.

(°) for the wash and dry cycle

(°) changes to these items shall not be considered relevant for the purposes of paragraph 4 of Article 4 of Regulation (EU) 2017/1369.

(°) if the product database automatically generates the definitive content of this cell the supplier shall not enter these data.

MAINTENANCES

Model	CIW-10715
Washing Capacity	10kg
Drying Capacity	7kg
Spin Speed	1500 rpm
Energy efficiency class 	A
Energy consumption of per cycle(to wash and dry a full capacity wash load at 60°C)	6.8kwh/Cycle
Water consumption of per cycle(Total)	160 L/cycle
Annual energy consumption(Using the dryer) 	1360kWh /annual
Annual water consumption(Using the dryer) 	32000L /annual
Annual energy consumption(Never Using the dryer) 	220kWh /annua
Annual water consumption(Never Using the dryer) 	14000L /annual
Washing performance class 	A
Spin- drying efficiency class 	B
Standard washing cycle	Intensive 60°C /1400RPM
Energy consumption of the Intensive 60°C at full load(Washing)	1.10kwh /cycle
Water consumption of the Intensive 60°C at full load(Washing)	70L/cycle
Remaining moisture content of the Intensive 60°C at full load(Washing)	53%
Programme duration of Intensive 60° C at full load(Washing)	340min
Energy consumption of the Dry at full load(Drying)	5.70kwh /cycle
Water consumption of the Dry at full load(Drying)	90L/cycle
Remaining moisture content of the Dry at full load(Drying)	0%
Programme duration of Dry at full load(Drying)	503min
Power consumption of off - mode	0.5W
Power consumption of Left on -mode	1.0W
Noise level of washing	57dB (A)
Noise level of spinning	80dB (A)
Noise level of drying	65dB (A)
Energy test program: Intensive;Speed:The highest speed; Temp.: 60°C;Other as the default.	

MAINTENANCES

Note!

- Programme setting for testing in accordance with applicable standard En60456 for wash.
- Programme setting for testing in accordance with applicable standard En50229 for wash and dry.
- When using the test programmes, wash the specified load using the maximum spin speed.
- The actual parameters will depend on how the appliance is used, and maybe different with the parameters in above mentioned table.
- The household washing machine is equipped with power management system. The duration of the left-on mode time is less than 10 minute.
- The noise emissions during washing/spinning for the standard washing cycle at full load.

Remarks:

- 1 The energy efficiency class is from A(highest efficiency) to D (lowest efficiency)
- 2 Energy consumption per year, based on 220 standard washing cycles for standard programme at 60°C and 40°C at full and partial load, and the consumption of the low-power modes. Actual energy consumption will depend on how the appliance is used.
- 3 Water consumption per year based on 220 standard washing cycles for standard programme at 60°C and 40°C at full and partial load. Actual water consumption will depend on how the appliance is used.
- 4 Spin-drying efficiency class from G (least efficient) to A (most efficient).
- 5 The standard 60°C programme and the standard 40°C programme are the standard washing programmes. These programmes are suitable to clean normally soiled cotton laundry and they are the most efficient programmes in terms of combined energy and water consumptions for washing that type of cotton laundry. The actual water temperature may differ from the declared cycle temperature. Please choose the suitable type of detergent for the various washing temperatures to get the best washing performance with less water and energy consumption.

NOTICE ABOUT RECYCLING



Your product is designed and manufactured with high quality materials and components which can be recycled and reused.

This symbol means that electrical and electronic equipment, at their end-of-life,

should be disposed of separately from your household waste. Please dispose of this equipment at your local community waste collection/ recycling centre.

In the European Union there are separate collection systems for used electrical and electronic products.

Please help us to conserve the environment we live in!

DECLARATION OF CONFORMITY

Herewith, we state that this product, complies with the requirements of below directives:

EMC-Directive: 14 / 30 / EU

Low Voltage Directive: 14/ 35 / EU

ErP Directive 09 / 125 / EC

CE Marking: 93 / 68 / EEC



RoHS Directive: 11 / 65 / EU & Delegated Directive (EU) 15 / 863

The detailed declaration of conformity can be found at

www.morris.gr



IMPORTER:

Kalliopi Karyda & Co, LP

87A, 17th November str.

55535, Pylea, Thessaloniki

Tel. 2316 006600

Fax. 2316 006650

www.morris.gr