

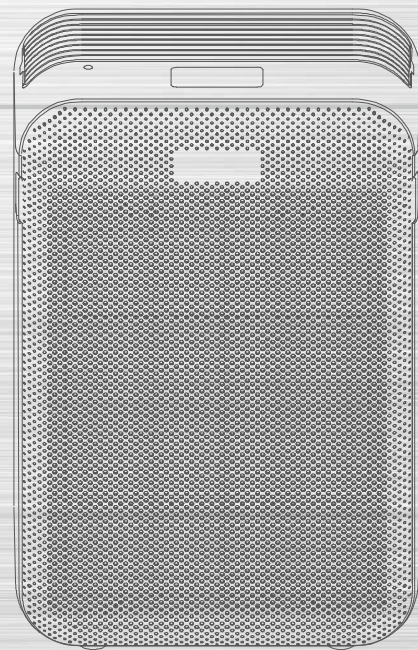

MORRIS

MAP-36013



USER MANUAL

AIR PURIFIER

Please read this manual carefully before use this product

CAUTION

Read the Rules for Safe Operation and Instructions carefully.

WARNING

1. If the supply cord is damaged, it must be replaced by the manufacturer, its service agent or a similarly qualified person in order to avoid a hazard.
2. This appliance can be used by children aged from 8 years and above and persons with reduced physical, sensory or mental capabilities or lack of experience and knowledge if they have been given supervision or instruction concerning use of the appliance in a safe way and understand the hazards involved. Children shall not play with the appliance. Cleaning and user maintenance shall not be made by children without supervision.
3.  Correct Disposal of this product
This marking indicates that this product should not be disposed with other household wastes throughout the EU. To prevent possible harm to the environment or human health from uncontrolled waste disposal, recycle it responsibly to promote the sustainable reuse of material resources. To return your used device, please use the return and collection systems or contact the retailer where the product was purchased. They can take this product for environmental safe recycling. The packaging material is recyclable. Dispose of the packaging in an environmentally friendly manner and make it available for the recyclable material collection-service.
4. Indoor and household use only.
5. When the appliance is not in use and before cleaning, unplug the appliance from the outlet.
6. To protect against the risk of electrical shock, do not immerse the unit, cord or plug in water or any other liquid.

7. Do not place other items on top of the appliance, and forbid sitting or standing on this appliance.
8. Only use the original filter provided by the supplier. In case of other filters, the best results cannot be achieved and damage can occur.
9. Do not insert fingers or objects into the air inlets or air outlets to prevent the product from physical damages or malfunction.
10. Please unplug the power cord immediately and contact the service center in time when the appliance suffers abnormal sound or burnt smell or smoke.
11. Do not spray flammable substances near the appliance; Do not spray water directly on the appliance or use chemical cleaners like alcohol or hydrochloric acid, etc.; Do not place water containers, medicines, or flammable materials on the appliance.
12. Do not block the air inlets/outlets of the appliance with any item.
13. This appliance cannot replace natural ventilation and other appliances like the vacuum cleaner, kitchen ventilator, etc.
14. When the appliance is working, it must be placed on a dry, flat and stable floor, with at least 30cm space reserved around it.
15. Do not put it in a place with direct sunlight.
16. To prevent electromagnetic disturbance, the appliance must keep a certain distance from the TV, radio, microwave oven and others.
17. The mist produced by an ultrasonic humidifier may affect the PM2.5 sensor accuracy on this appliance, and both devices should maintain a certain distance.
18. Do not disassemble or modify this appliance without authorization to avoid accidents.
19. Do not pull the power cord to move the appliance.
20. This appliance incorporates an earth connection for functional purposes only.

Product Instruction

Attention

The pictures contained in the Manual are for reference only, and please be subject to the physical product in the packing box.

Component name

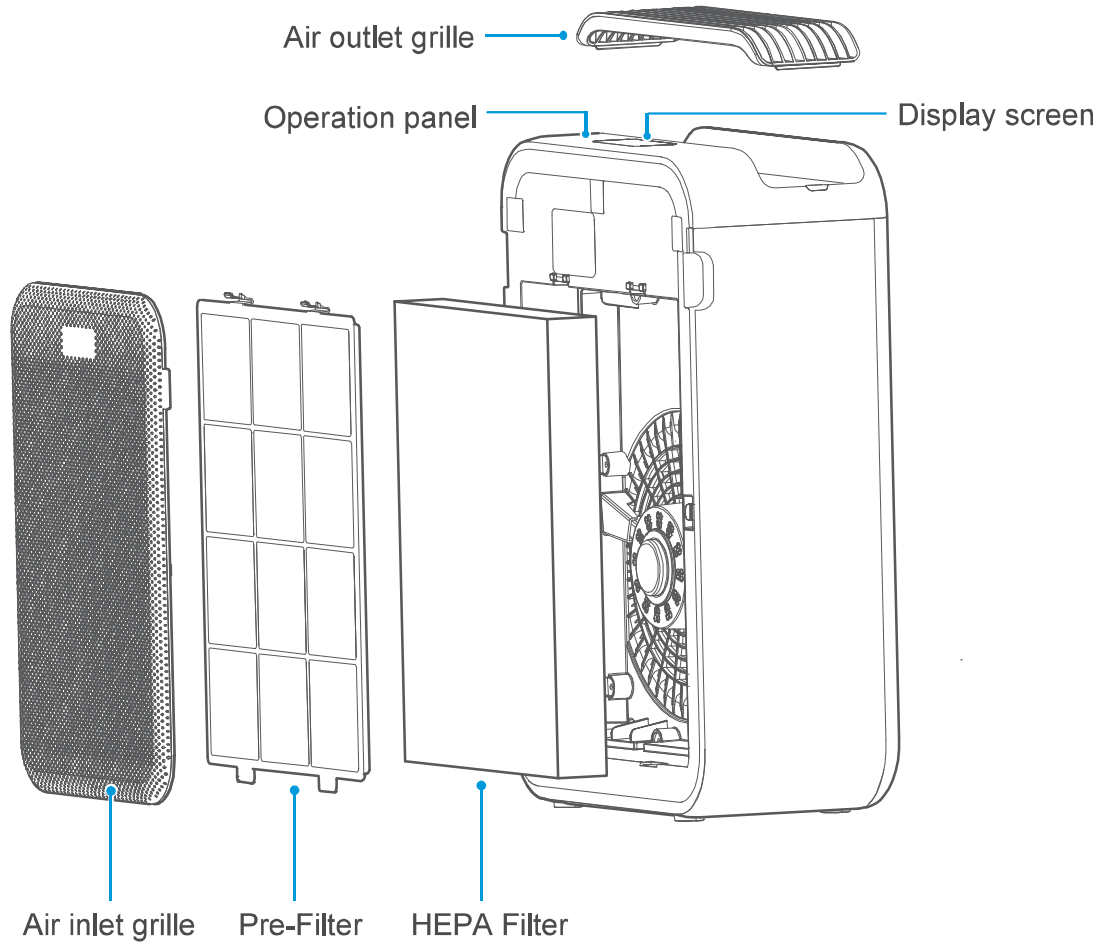

Main body



Protective bag

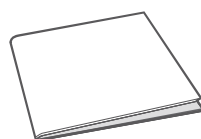

Manual

Installation Instructions

Installation steps

- 1** Remove the air inlet grill

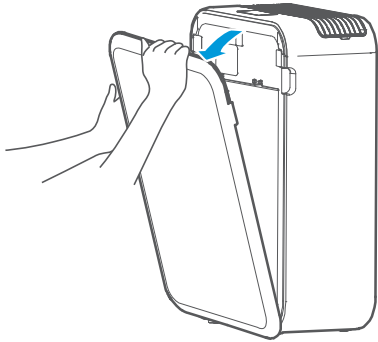

- 2** Take out the Pre-Filter
Press down and pull the U-shaped snap joint, and take out the Pre-Filter.

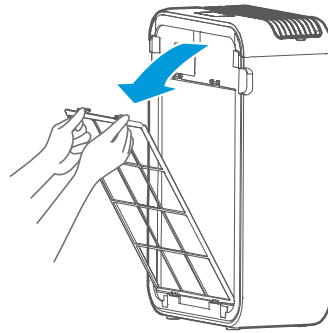

- 3** Take out the HEPA filter
Hold both sides of the HEPA filter with both hands, and take it out

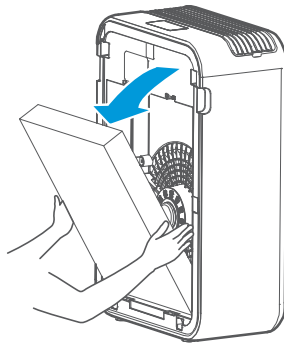

- 4** Remove the protective film of the filter assembly

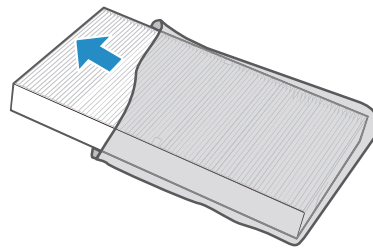

- 5** Install the HEPA filter

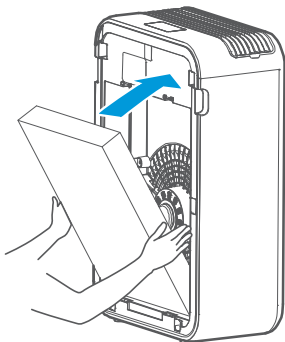

- 6** Install the Pre-Filter
Align the slot position at the bottom, and click into the upper U-shaped snap joint.

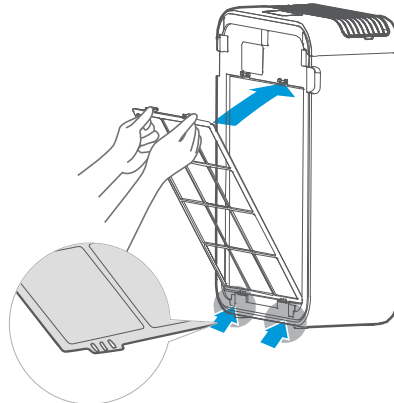

- 7** Install the air inlet grill

Align the slot position at the bottom, press both sides of the upper part of the air inlet grill, and buckle up the air inlet grill.

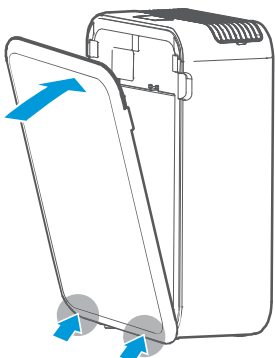

- 8** Plug the power supply

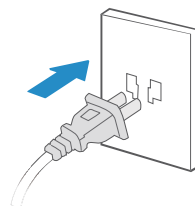

Instructions

Control panel

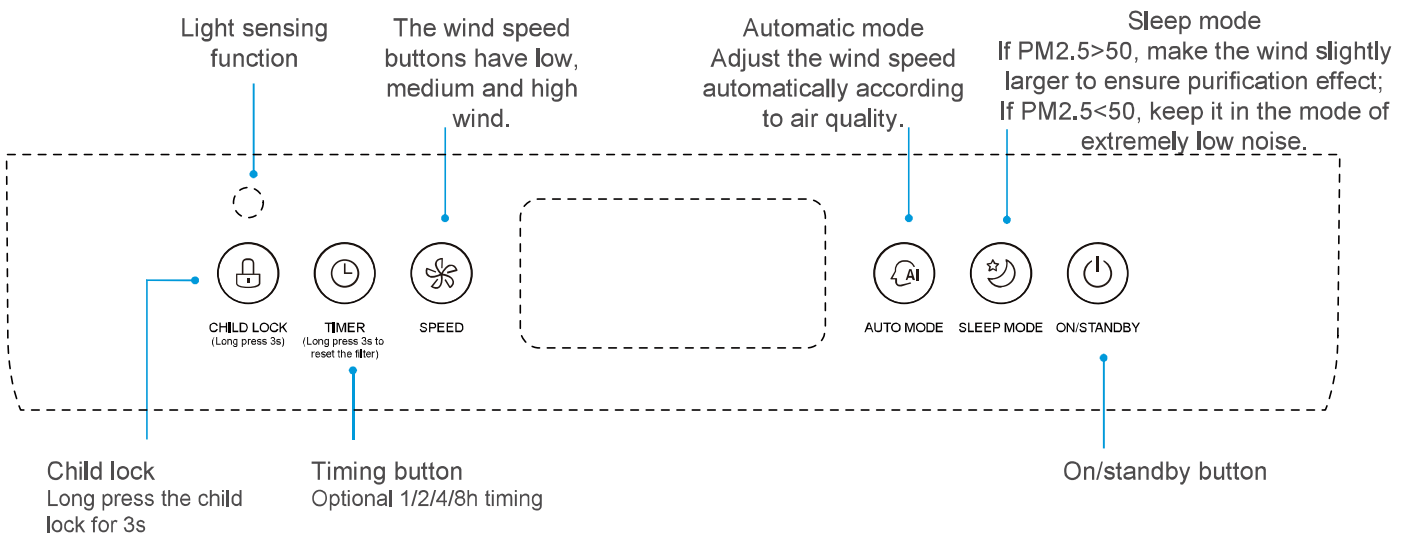

Display panel

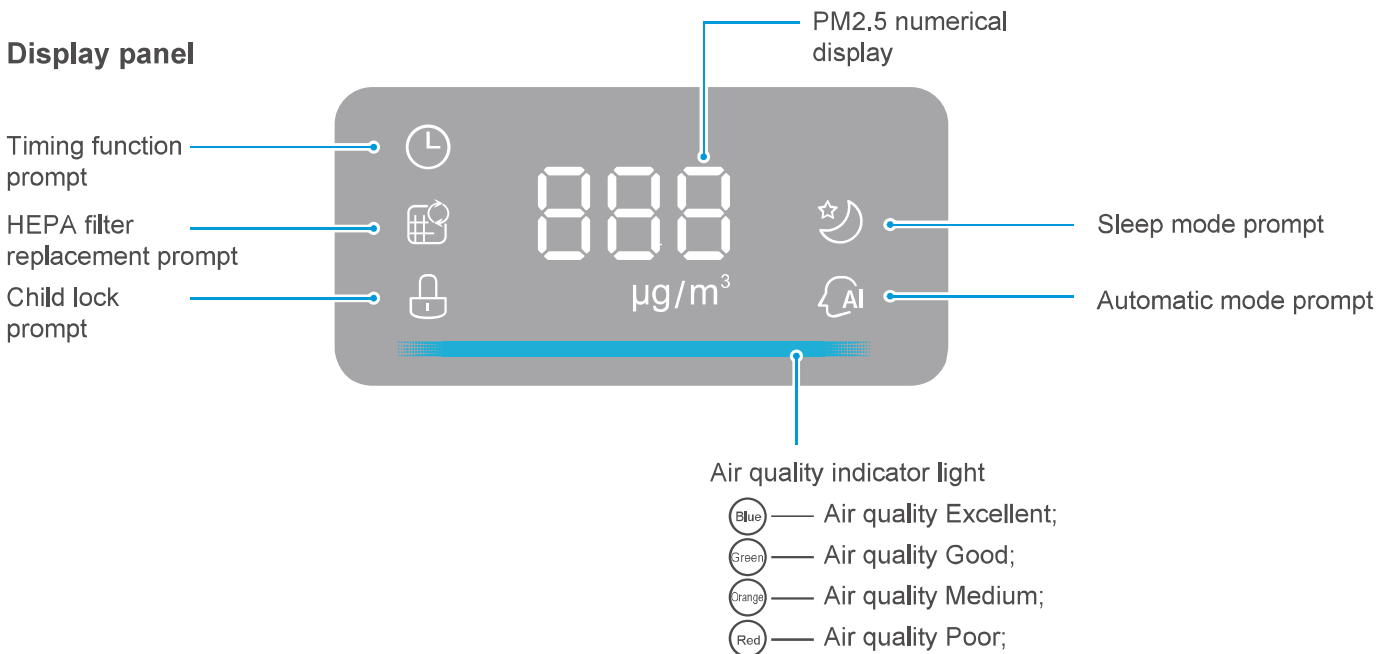

Test Run

⚠ Attention

- This appliance has the function of disassembling protection, so it cannot be started normally until all air inlet grilles are installed correctly.
- In case of continuous electricity, enter the working mode before the standby state, after each power on.
- The appliance is connected to the power again after unexpected power outage (when the power is off or the power cord is unplugged during normal operation), and then restores to the working state before the power outage.

1 Preparation

Power on for the first time, the display panel flashes for 1s, and then the screen is turned off. The appliance is at a standby state;



2 Remove the protective film of the filter assembly.

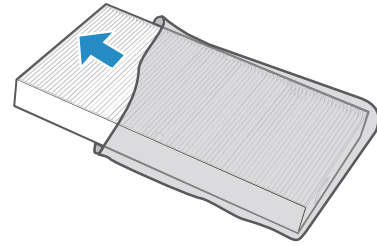

3 Install the filter

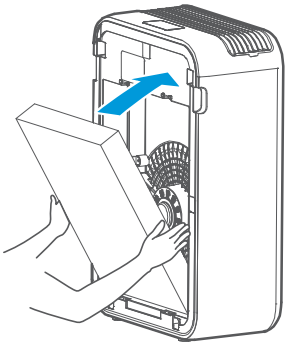

4 On/standby

Press the on/standby button

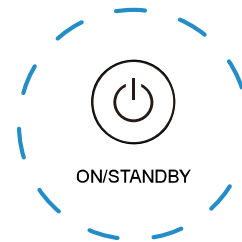

5 Warm up

When the particulate matter sensor enters the warm-up state, PM2.5 numerical display shows "---", and is normal after 10s.



6 Work

The purifier is powered on for the first time and then enters the automatic mode.



Cleaning and Maintenance

Body cleaning

⚠ Attention

- Be sure to turn it off before any maintenance, and cut off power.

Host

Wipe the body with a soft towel.

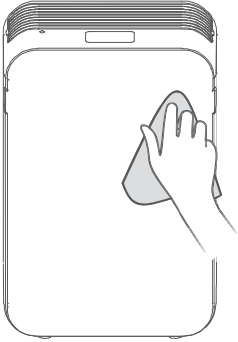

Air inlet grille

Open the air inlet grille, vacuum up dust with a vacuum cleaner or wipe it with a cloth.

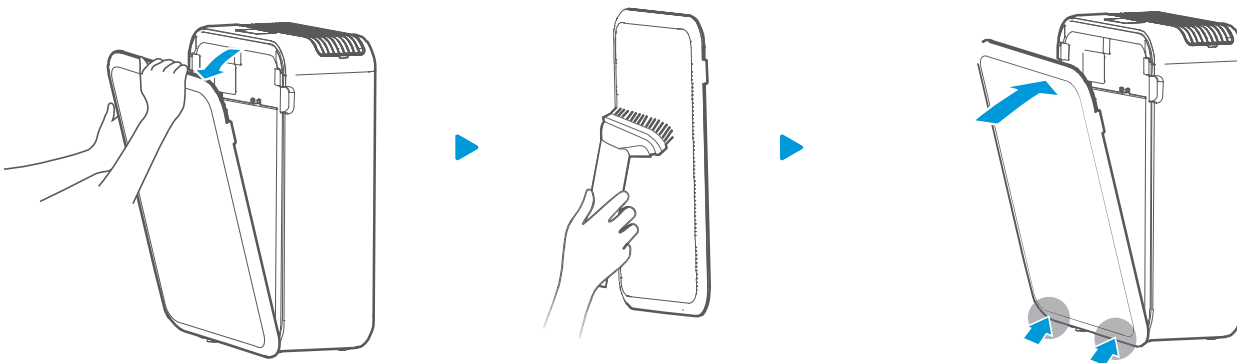

Air outlet grille

Remove the air outlet grille, vacuum up dust with a vacuum cleaner or wipe it with a cloth



Cleaning of the Pre-Filter

- It is recommended to clean the Pre-Filter at least once every two weeks. The cleaning cycle can be based on the usage environment and time, seriously polluted environment should be cleaned frequently.

1 Unplug the appliance, and take out the Pre-Filter.

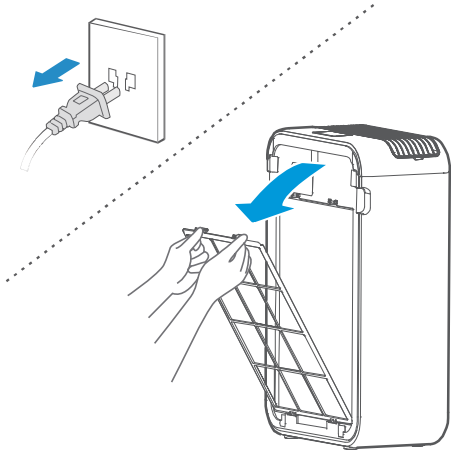

2 Vacuum the dust or wipe it with a cloth.

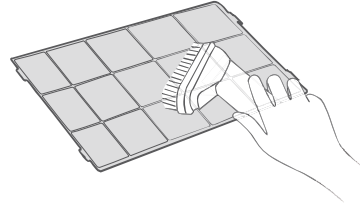

3 If there is a lot of dirt, the common kitchen detergents is diluted and used first, and then do the cleaning.



Soaking time is about 10min.

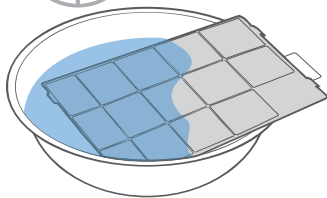

4 Dry the Pre-Filter

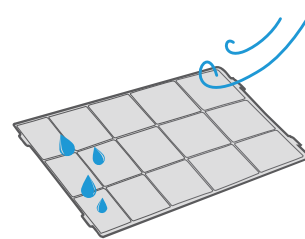

5 Assemble the Pre-Filter and the Air inlet grille

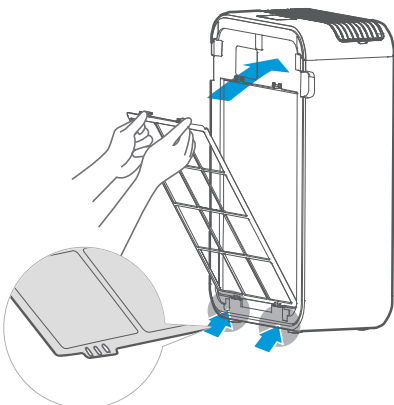

6 Plug in the appliance, and start it.

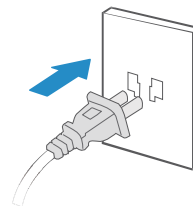

Replacement of the filter components

- 1** Filter model:
FC-35S1A (included 1)

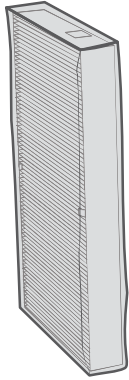

- 2** When the filter replacement light is on, it reminds that the HEPA filter should be replaced. If it is not replaced in time, the prompt will appear in every startup.



- 3** Replace with a new filter

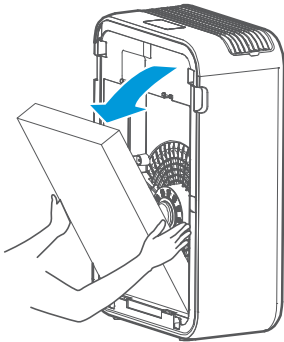

- 4** Long press the timing button for 3s, reset the HEPA filter reminder.

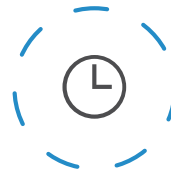

Long press for 3s

Service Guide

Faults Handling

Before inviting someone to inspect or repair, please check the following items.

Error code	Error description	Handling method
E1	Disassembly protection reminder	Properly installed inlet grille
E2	Sensor failure	Contact the after-sales
E3	Abnormal fan speed	Contact the after-sales

NOTICE ABOUT RECYCLING



Your product is designed and manufactured with high quality materials and components which can be recycled and reused. This symbol means that electrical and electronic equipment, at their end-of-life, should be disposed of separately from your household waste. Please dispose of this equipment at your local community waste collection/ recycling centre.

In the European Union there are separate collection systems for used electrical and electronic products.

Please help us to conserve the environment we live in!

DECLARATION OF CONFORMITY

Herewith, Kalliopi Karyda & CO. LP states that this product complies with the requirements of below directives:

EMC-Directive: 14 / 30 / EU

Low Voltage Directive: 14/ 35 / EU

RoHS Directive: 11 / 65 / EU & 15 / 863 / EU

CE-Marking Directive: 93 / 68 / EEC

The detailed declaration of conformity can be found at

www.morris.gr





IMPORTER:

Kalliopi Karyda & Co, LP

87A, 17th November str.

55535, Pylea, Thessaloniki

Tel. 2316 006600

Fax. 2316 006650

www.morris.gr