

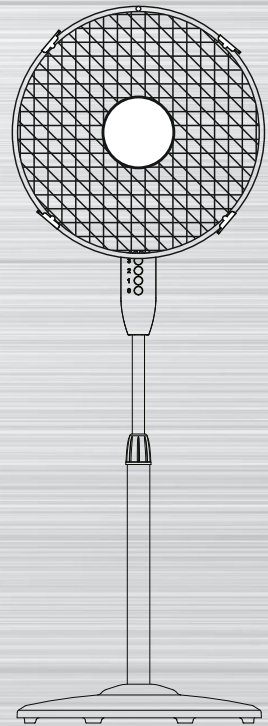

MORRIS

MFS-16239



USER MANUAL

STAND FAN

Please read this manual carefully before use this product

CAUTION

Read Rules for Safe Operation and Instructions Carefully.

WARNING

1. If the supply cord is damaged, it must be replaced by manufacturer or its service agent or a similarly qualified person in order to avoid a hazard.
2. Indoor use only.
3. To protect against the risk of electrical shock, do not immerse the unit, cord or plug in water or other liquid.
4. Switch the fan OFF and unplug it from the outlet when it is not in use, when moving it from one location to another and before cleaning.
5. When the fan was assembled, the motor blade guard shall not be taken off anymore.
6. This appliance can be used by children aged from 8 years and above and persons with reduced physical, sensory or mental capabilities or lack of experience and knowledge if they have been given supervision or instruction concerning use of the appliance in a safe way and understand the hazards involved. Children shall not play with the appliance. Cleaning and user maintenance shall not be made by children without supervision.
7. Children of less than 3 years should be kept away unless continuously supervised. Children aged from 3 years and less than 8 years shall only switch on/off the appliance provided that it has been placed or installed in its intended normal operating position and they have been given supervision or instruction concerning use of the appliance in a safe way and understand the hazards involved. Children aged from 3 years and less than 8 years shall not plug in, regulate and clean the appliance or perform user maintenance.

RULES FOR SAFE OPERATION

- Never insert fingers, pencils, or any other object through the grille when fan is
1. running.
 2. Disconnect the fan when moving from one location to another.
 3. Be sure the fan is on a stable surface when operating to avoid overturning.
 4. DO NOT use the fan in window, rain may create electrical hazard.

INSTALLATION INSTRUCTIONS

■ Name of components

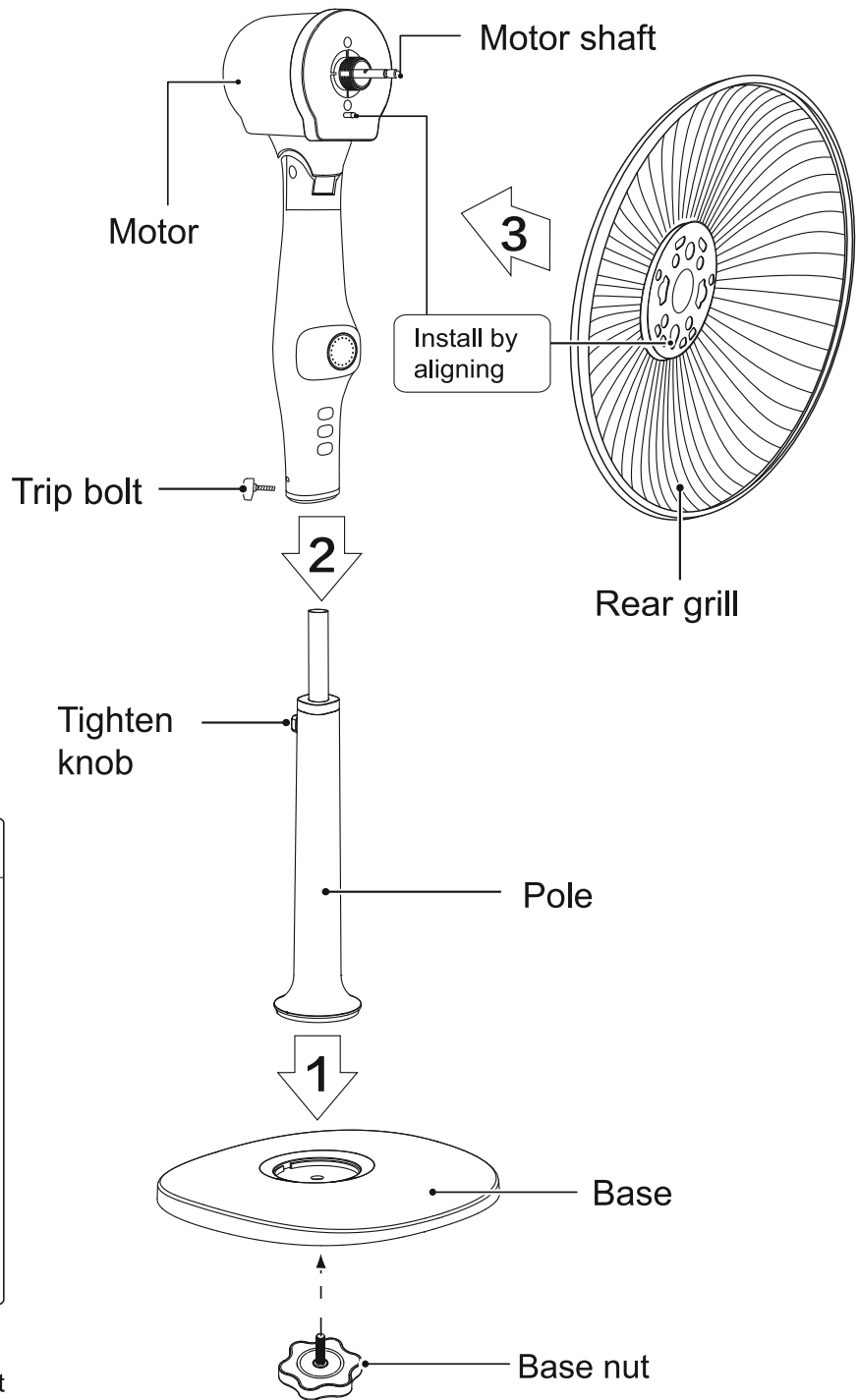

Base Installation

Align the column with the groove on the base and fixate them using the Base Nut.

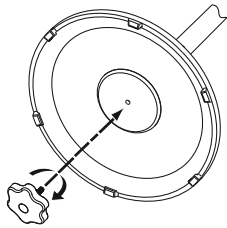

Considerate Hint:
Remove parts from the component before performing installation.

Front and Rear Guard Installation

Align catch of the front guard with the illustrated position of the rear guard.

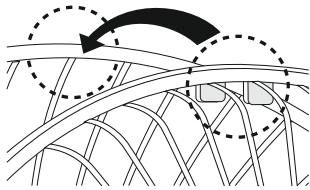

Press guards sequentially with both hands.

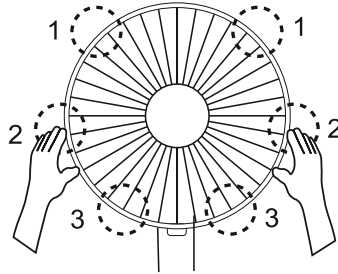

Self-Catch Installation.

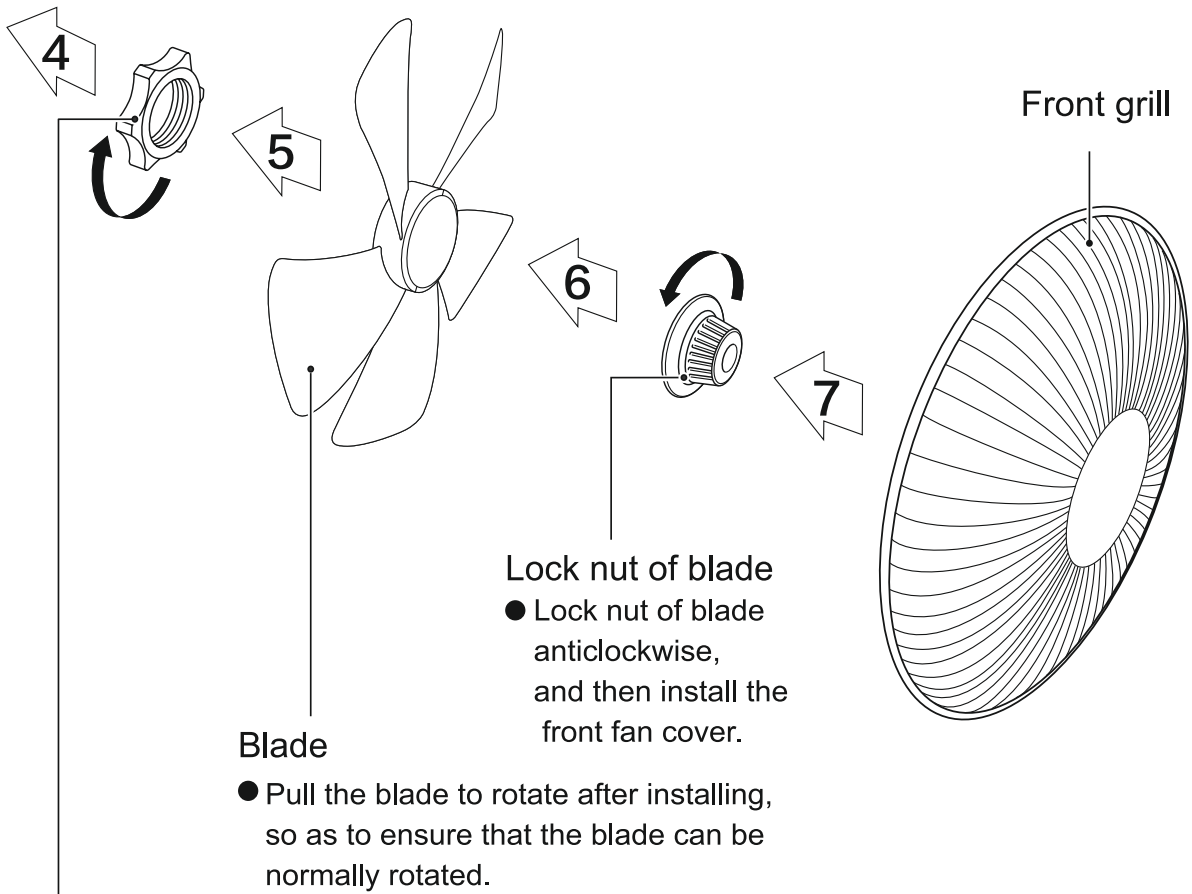
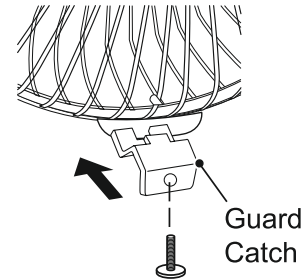

Lock nut of grill

- Screw the lock nut of grill clockwise, and in the meantime, fix the rear grill.

INSTRUCTIONS FOR USE

■ Instructions for key of remote controller

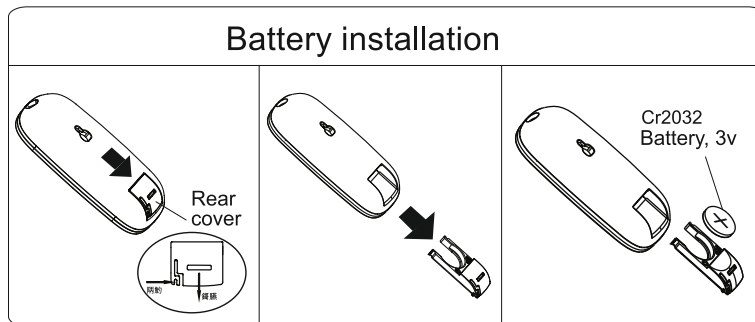
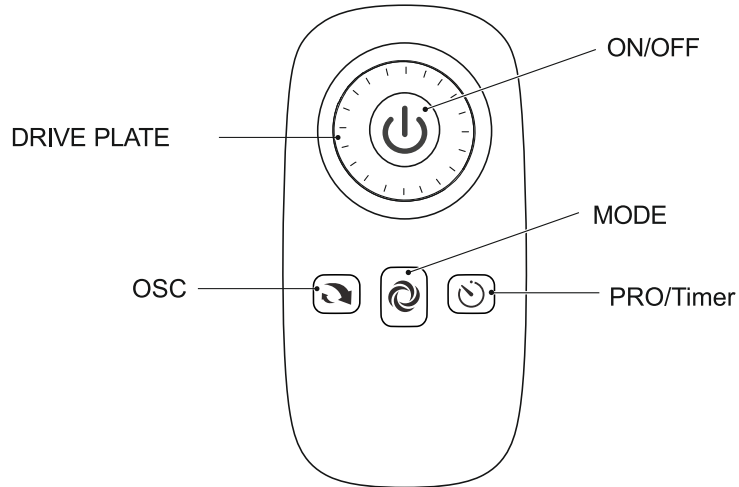

It uses one button battery of type "CR2032".

Considerate Hint:

1. Install the battery with positive side facing up.
2. Effective Range of Remote Control: within 5 m distance and 30-degree deflection in front of product.

■ Instructions for display of body

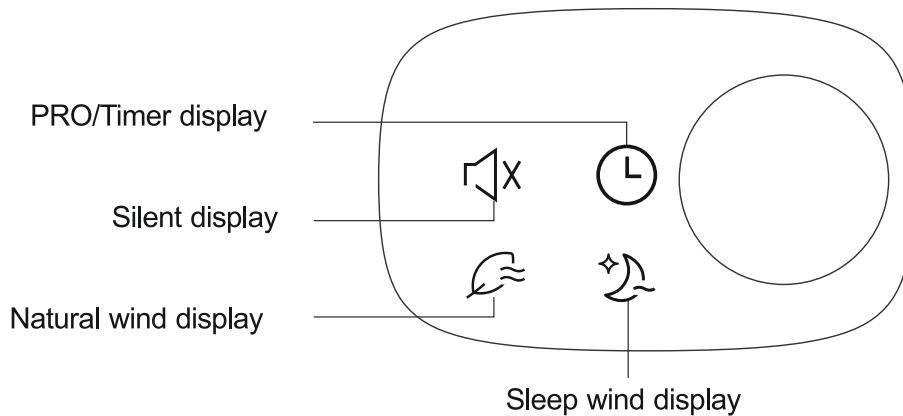

INSTRUCTIONS FOR USE

■ Instructions for operation of body

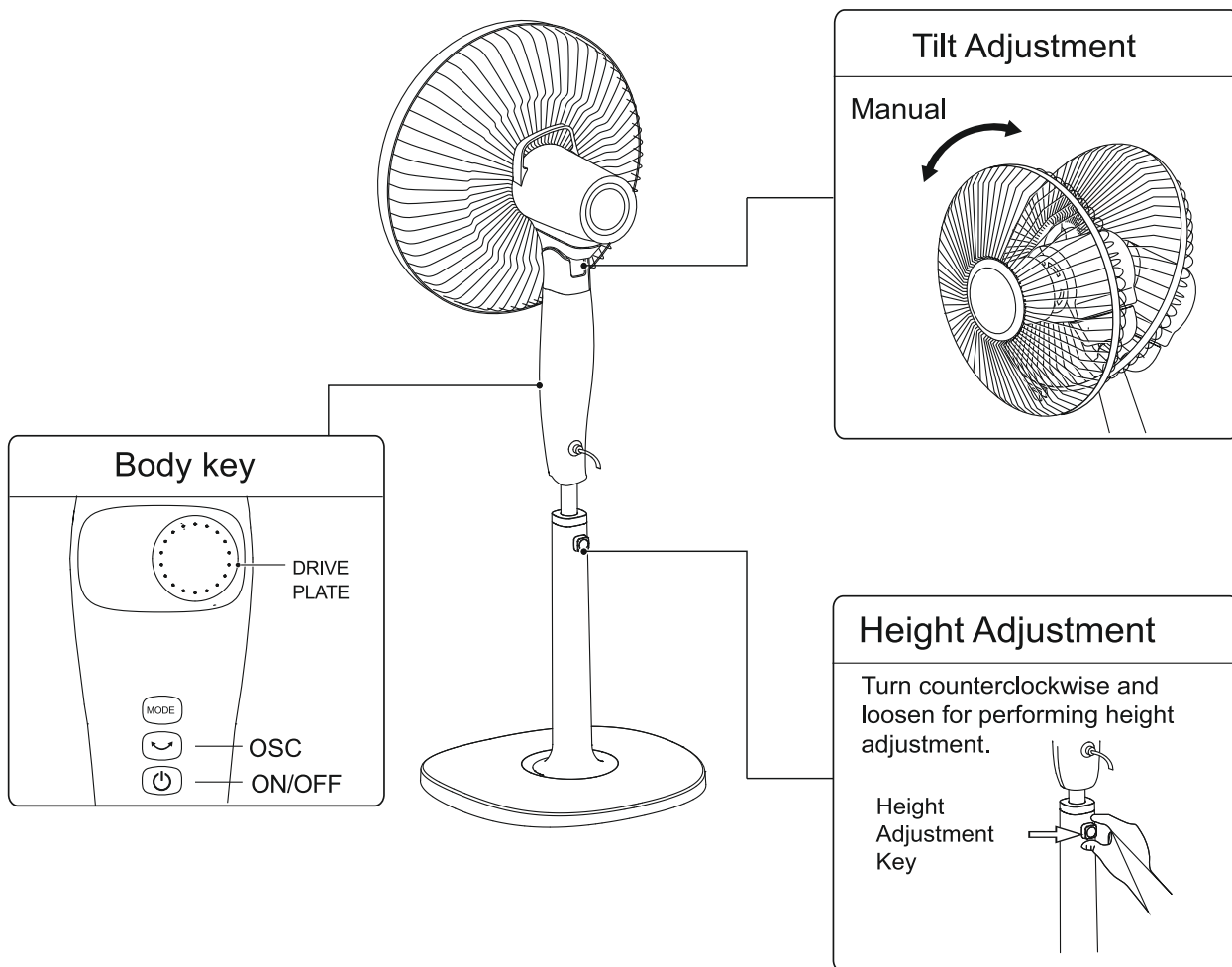

MAINTENANCE INSTRUCTION

The fan requires little maintenance. Do not try to fix it by yourself. Refer it to qualified service personnel if service is needed.

1. Before cleaning and assembling, fan must be unplugged.
2. To ensure adequate air circulation to the motor, keep vents at the rear of the motor free of dust. Do not disassemble the fan to remove dust.
3. Please wipe the exterior parts with a soft cloth soaking a mild detergent.
4. Do not use any abrasive detergent or solvents to avoid scratching the surface.
Do not use any of the following as a cleaner: gasoline, thinner.
5. Do not allow water or any other liquid into the motor housing or interior parts.

CLEANING

1. Be sure to unplug from the electrical supply source before cleaning.
2. Plastic parts should be cleaned with a soft cloth moisten with mild soap.
Thoroughly remove soap film with dry cloth.

NOTICE ABOUT RECYCLING



Your product is designed and manufactured with high quality materials and components which can be recycled and reused. This symbol means that electrical and electronic equipment, at their end-of-life, should be disposed of separately from your household waste. Please dispose of this equipment at your local community waste collection/ recycling centre.

In the European Union there are separate collection systems for used electrical and electronic products.

Please help us to conserve the environment we live in!

DECLARATION OF CONFORMITY

Herewith, Kalliopi Karyda & Co Lp. states that this product, complies with the requirements of below directives:

EMC-Directive: 14 / 30 / EU

Low Voltage Directive: 14/ 35 / EU

ErP Directive 09 / 125 / EC

CE Marking: 93 / 68 / EEC

RoHS Directive: 11 / 65 / EU & 15 / 863 / EU

The detailed declaration of conformity can be found at www.morris.gr





EXCLUSIVE DISTRIBUTOR

Kalliopi Karyda & Co Lp

87A, 17th November str.

55535, Pylea, Thessaloniki

Tel. 2316006600

Fax. 2316006650

www.morris.gr