



MORRIS

OIL FILLED RADIATOR



Model: MHR-20027

INSTRUCTIONS FOR USE

This product is only suitable for well insulated spaces or occasional use.

PLEASE READ AND SAVE THESE IMPORTANT INSTRUCTIONS FOR FUTURE REFERENCE.

IMPORTANT SAFEGUARDS

When using an electrical appliance, basic safety precautions should always be observed, including the following:

READ ALL INSTRUCTIONS BEFORE USING

WARNING: To reduce the risk of fire, electrical shock, or injury to person:

1. This appliance can be used by children aged from 8 years and above and persons with reduced physical, sensory or mental capabilities or lack of experience and knowledge if they have been given supervision or instruction concerning the use of the appliance in a safe way and understand the hazards involved. Children shall not play with the appliance. Cleaning and user maintenance shall not be made by children without supervision.

2. Children of less than 3 years should be kept away unless continuously supervised. Children aged from 3 years and less than 8 years shall only switch on/off the appliance provided that it has been placed or installed in its intended normal operating position and they have been given supervision or instruction concerning use of the appliance in a safe way and understand the hazards involved. Children aged from 3 years and less than 8 years shall not plug in, regulate and clean the appliance or perform user maintenance.

3. CAUTION - Some parts of this product can become very hot and cause burns. Particular attention has to be given where children and vulnerable people are present.

4. If the supply cord is damaged, it must be replaced by the manufacturer, its service agent or similarly qualified persons in order to avoid a hazard.



5. **WARNING:** In order to avoid overheating, do not cover the heater.

6. Always disconnect the heater from the main supply when not in use and when cleaning.

7. Do not leave the heater unattended while in operation.

8. Never cover the heater as this may lead to risk of fire.

9. Keep a distance of at least 1m between the heater and any combustible material, such as furniture, curtains, bedding cloths or papers.

10. Keep the heater clean. Do not allow objects to enter the ventilation, as this may cause electric shock, fire, or damage the heater.

11. Close supervision is required when any appliance is used near or by children.

12. Never allow the cord to get in touch with wet or hot surfaces, become twisted or be within the reach of children.

13. Do not use outdoors.

14. Do not place on or near a hot gas or electric burner.

15. Never use the appliance with a damaged cord or plug or after the appliance has malfunctioned or has been damaged in any way.

16. Never attempt to open any part or dismantle the controls.

17. Responsibility for failure cannot be accepted if these instructions have been ignored.

18. Do not use the appliance for anything other than its intended use.

19. This appliance is intended for household use only.

20. Follow the regulations concerning the disposal of the oil when scraping the appliance.

21. Any repair must be referred to an authorized service agent only.

22. If the supply cord is damaged, it must be replaced by the manufacturer or its service agent

in order to avoid a hazard.

23.The heater must not be located immediately below a socket-outlet.

24.Do not use this heater in the immediate surroundings of a bath, a shower or a swimming pool.

FOR HOUSEHOLD USE ONLY
SPECIFICATIONS

MODEL	FINS	RATED VOLTAGE	RATED POWER
MHR-20027	13	220-240V~50/60Hz	2500W

STRUCTURE AND PARTS

MHR-20027:



- A – carry handle
- B – thermostat knob
- C – indicator light
- D – power switch
- E –timer
- F –cord wrap
- G- castor

ASSEMBLY INSTRUCTIONS

The heater is packaged with the feet unattached. You must attach them before operating the heater.

WARNING: Do not operate without the feet attached. Do operate the heater only in an upright position (feet on the bottom, controls on the top), any other position could create a hazardous situation.

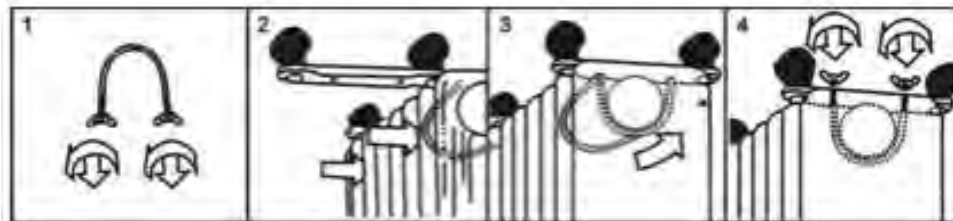

1. Place the radiator body upside-down on a scratch-free location, make sure it is stable and

that it will not fall.

2. Unscrew the wing nuts from the U-shaped bolt provided, attach the U-shaped bolt to the U-facing flange between first and second fins (near the front cover).
3. To attach the castor mounting plate to the radiator body, you should insert the threaded ends of the U bolt in the holes on the castor mounting plate.
4. Screw the wing nuts back to the U bolt and fasten the wing nut properly.

Note: do not over tighten, as this might cause the damage of the radiator flange.

5. Unscrew the spherical nut from the castor, align the shaft to the hole of the castor mounting plate, insert in, and screw on the spherical nut.

6. Repeat 2, 3, 4 and 5 on the rear side of the radiator for the mounting of the rear castors.

Note: the rear castors must be mounted between the end side two fins.

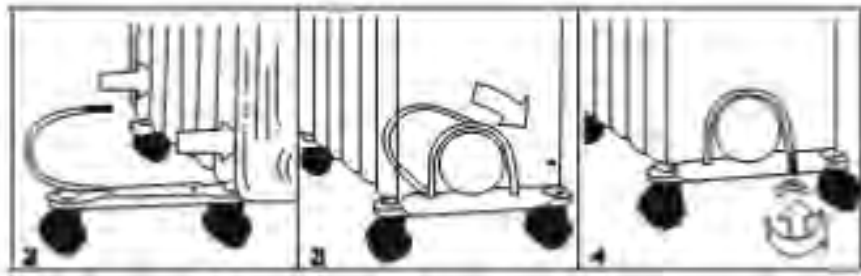

INSTRUCTIONS FOR USE

With the thermostat control switch and the power setting switches in the '0' position, plug the heater into the main power supply.

1. Room temperature can be adjusted using the thermostat. Turn the thermostat knob clockwise, to increase the heat, and anti-clockwise to decrease the temperature, until you reach the desired temperature.
2. Switch the heater to one of the following power settings.
 - a) Turn switch to one (I) for 1000W
 - b) Turn switch to two (II) for 1500W
 - c) Turn switch to three (III) for 2500W
3. The power switch lights up, when activated.
4. Turning the thermostat control clockwise will increase the "set" temperature.
5. Turning the thermostat anti-clockwise will decrease the "set" temperature.
6. Once you have finished using your heater, turn the power switches, and the thermostat control switch to the "0" positions, and unplug from the mains supply.

USE OF TIMER

1. Regulate the time of the timer according to the clock by turning it clockwise (DO NOT TURN IT COUNTER CLOCKWISE).

2. The timer has a small switch; the function is as follow:

I= Unit is always ON;

⌚=Timer function is ON.

3. Set the timer to ⌚ position. There are 96 small plastic pins on the timer, each correspond to a 15 minutes interval. Push outward the pins corresponding to the time you want the heater to turn ON and push inward the pins corresponding to the time you want the heater to turn OFF.



CAUTION-

A. Do not use the timer function unattended.

B. The heater will not operate if the timer is set to the position and the pins are not activated according to the times required.

C. If the heater loses its electricity supply, e.g. Switched off at the mains socket or in the event of a power failure, the time should be reset after the power on again.

4. The pilot light will be on when the timer is set to ON position or the timing function is activated.

MAINTENANCE

1. Always remove the plug from the socket-outlet and allow the radiator to cool down before cleaning the heater.

2. Wipe the radiator with a soft damp (not wet) cloth.

WARNING:

Do not immerse the heater in water.

Do not use any cleaning chemicals such as detergents and abrasives.

Do not allow the interior to get wet as this could create a hazard.

3. To store away the heater, wind the cable round the bobbin and store the heater in a clean dry place.

4. In case of malfunction or doubt, do not try to repair the radiator yourself, it may result in a fire hazard or electric shock.

Model identifier(s): MHR-20027					
Item	Symbol	Value	Unit	Item	Unit
Heat output				Type of heat input, for electric storage local space heaters only (select one)	
Nominal heat output	P_{nom}	2,5	kW	manual heat charge control, with integrated thermostat	[no]
Minimum heat output (indicative)	P_{min}	1	kW	manual heat charge control with room and/or outdoor temperature feedback	[no]
Maximum continuous heat output	$P_{max,c}$	2,5	kW	electronic heat charge control with room and/or outdoor temperature feedback	[no]
Auxiliary electricity consumption				fan assisted heat output	[no]
At nominal heat output	$e_{l_{max}}$	N/A	kW	Type of heat output/room temperature control (select one)	
At minimum heat output	$e_{l_{min}}$	N/A	kW	single stage heat output and no room temperature control	[no]
In standby mode	$e_{l_{SB}}$	0	kW	Two or more manual stages, no room temperature control	[no]
				with mechanic thermostat room temperature control	[yes]
				with electronic room temperature control	[no]
				electronic room temperature control plus day timer	[no]
				electronic room temperature control plus week timer	[no]
				Other control options (multiple selections possible)	
				room temperature control, with presence detection	[no]
				room temperature control, with open window detection	[no]
				with distance control option	[no]
				with adaptive start control	[no]
				with working time limitation	[no]
				with black bulb sensor	[no]
Contact details	Kalliopi Karyda & Co LP 87A, 17th Noemvriou str, P.C. 55535 Thessaloniki – Greece T: +302316006600 F: +30231600550				

NOTICE ABOUT RECYCLING



Your product is designed and manufactured with high quality materials and components which can be recycled and reused.

This symbol means that electrical and electronic equipment, at their end-of-life, should be disposed of separately from your household waste.

Please dispose of this equipment at your local community waste collection/recycling centre. In the European Union there are separate collection systems for used electrical and electronic products.

Please help us to conserve the environment we live in!

DECLARATION OF CONFORMITY

Herewith, Kalliopi Karyda & Co LP. states that this product, complies with the requirements of below directives:

EMC-Directive: 14 / 30 / EU

Low Voltage Directive: 14/ 35 / EU

CE Marking: 93 / 68 / EEC

RoHS Directive: 11 / 65 / EU & 15 / 863 / EU

The detailed declaration of conformity can be found at www.united-electronics.gr



EXCLUSIVE IMPORTER IN GREECE:

Kalliopi Karyda & Co LP

87A, 17th November Str - P.C. 55535

Pylaia - Thessaloniki - Greece

T: 2316006600 | F: 2316006650

www.united-electronics.gr